



**CITY OF HIGHLAND
BUILDING & SAFETY DIVISION**

27215 Baseline St., Highland Ca, 92346

Permit Counter: (909) 864-8732 X 232 | Inspection Request Line 909-864-8732 X 228

Commercial Site Plan

Please use a separate sheet of paper for each plan

1. Plans should accurately depict the building or unit within the site. Please show any detached storage structures or other buildings on the property, indicate the location of streets, driveways, alley ways, parking areas, landscaped areas, fences, etc.
2. Plans should be legible and to some discernable scale with a north facing arrow.
3. Provide the square feet of the building or tenant space and Unit number if applicable
4. Include owners name and phone number, address or assessors parcel number, name and type of business
6. Submit 3 copies of the plans to the city

Note: Poorly drawn plans could cause delays and may be rejected.

Please contact Building and Safety staff should you have any questions. 909-864-8732

- Please note this is only an EXAMPLE -

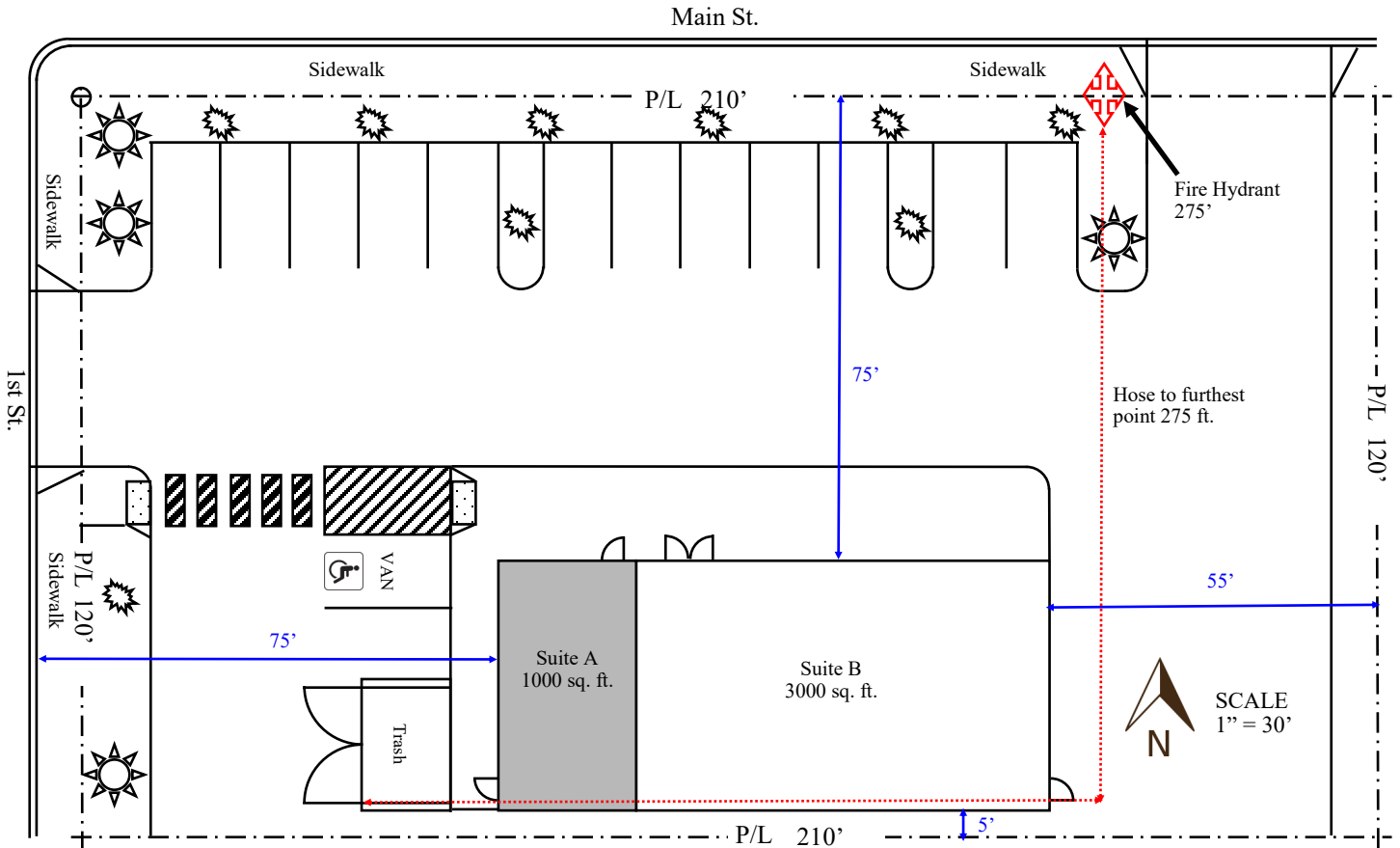

Owners Name Telephone Number Email	General Store Address: 1234 Main St. Suite A	Date: 04/1/2021 Scale: 1" = 30'
--	---	------------------------------------